



700 Series Anti-vandal

Door furniture



The Legge commercial range of anti-vandal door furniture has been designed for use on commercial applications, including interior and exterior doors that will be subject to vandalism and abuse.



Features

- Constructed of quality components, with **forged brass levers and plates**
- Heavy duty spring provides a smooth, fast return action of the lever and minimises droop extending the life of the furniture
- Lever hub reinforced to withstand high levels of abuse
- Shear off spindles supplied with lock to minimise potential lock damage
- Supplied as standard with triwing security screws
- Suitable for doors 35mm to 50mm
- Furniture re-handed by simple relocation of stop block
- Suitable for use on fire door assemblies when used with fire rated locks and latches

Warranties	
Mechanical	30 years
Finish	allegion.co.nz/finisheswarranty

Specification guide

Function	Lever	Finish
refer following pages	Alpha 29 Leonardo 12	Chrome plate C Polished brass P Satin chrome plate S

- Function
Select the desired function e.g. External cylinder Hole L702AV
- Lever
Select the required lever design e.g. Leonardo #12 L702AV/12
- Finish
Select the desired finish e.g. Satin chrome plate L702AV/12S

Finishes



CP

Chrome Plate



PB

Polished Brass



SCP

Satin Chrome Plate

Legend

Turn snib	
Cylinder hole	
Emergency button	

Plate function options

External plates

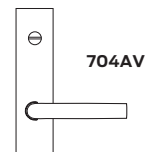
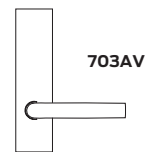
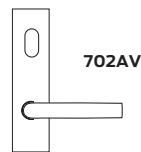

Internal plates

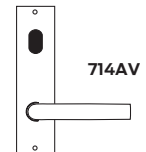
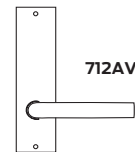
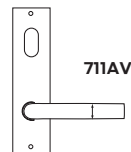

Specifications

Door type	Timber or metal
Door thickness	32mm to 50mm
Fixing centres	158mm
Plate height	171mm
Plate width	47mm
Plate thickness	11mm
Lever to cylinder centres	63.5mm
Spindle size	7.6mm
Compatible locks/latches	Legge 990MF Series mortice locks
Fixing	Back to back, external plates concealed fixing, screws supplied with exterior plates only, screw length 75mm
Materials	Forged brass

Testing and Compliance



Fire Rating:

Successfully tested on fire door assemblies in accordance with AS1905 Part1: Fire resistance doorsets. Check with fire door manufacturer prior to installation.



Accessibility:

Compliant to the AS 1428:1-2009 Design for Access and Mobility

Caution:

When door closers are installed and adjusted to meet reduced opening force requirements, there may be insufficient power to reliably close and latch the door, depending on prevailing operating conditions.

Note:

In areas of high wind pressure and/or air conditioning pressures, the LCN Automatic Door Operators are recommended.

Legge 700 Series Anti-vandal levers

702AV

External plate with cylinder hole



711AV

Internal plate with cylinder hole



704AV

External plate with emergency release



714AV

Internal plate with turn



703AV

External plain plate



712AV

Internal plain plate



All shown as 700 Series with Alpha lever in a chrome finish. Also available with Leonardo lever

Lever dimensions

Alpha #29 

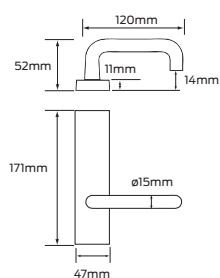

Leonardo #12

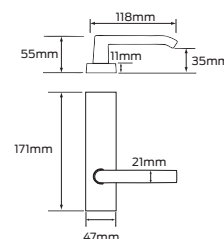

Legge 700 Series spare parts

Triwing security screws

